

ENCÜMEN KARAR KROKİ

İLİ	GAZİANTEP
İLÇESİ	OĞUZELİ
MAHALLESİ	KÖRKÜN
ADA/PARSEL	394/3, vs. 1039/4,5 vs. 1135/14,15, vs.

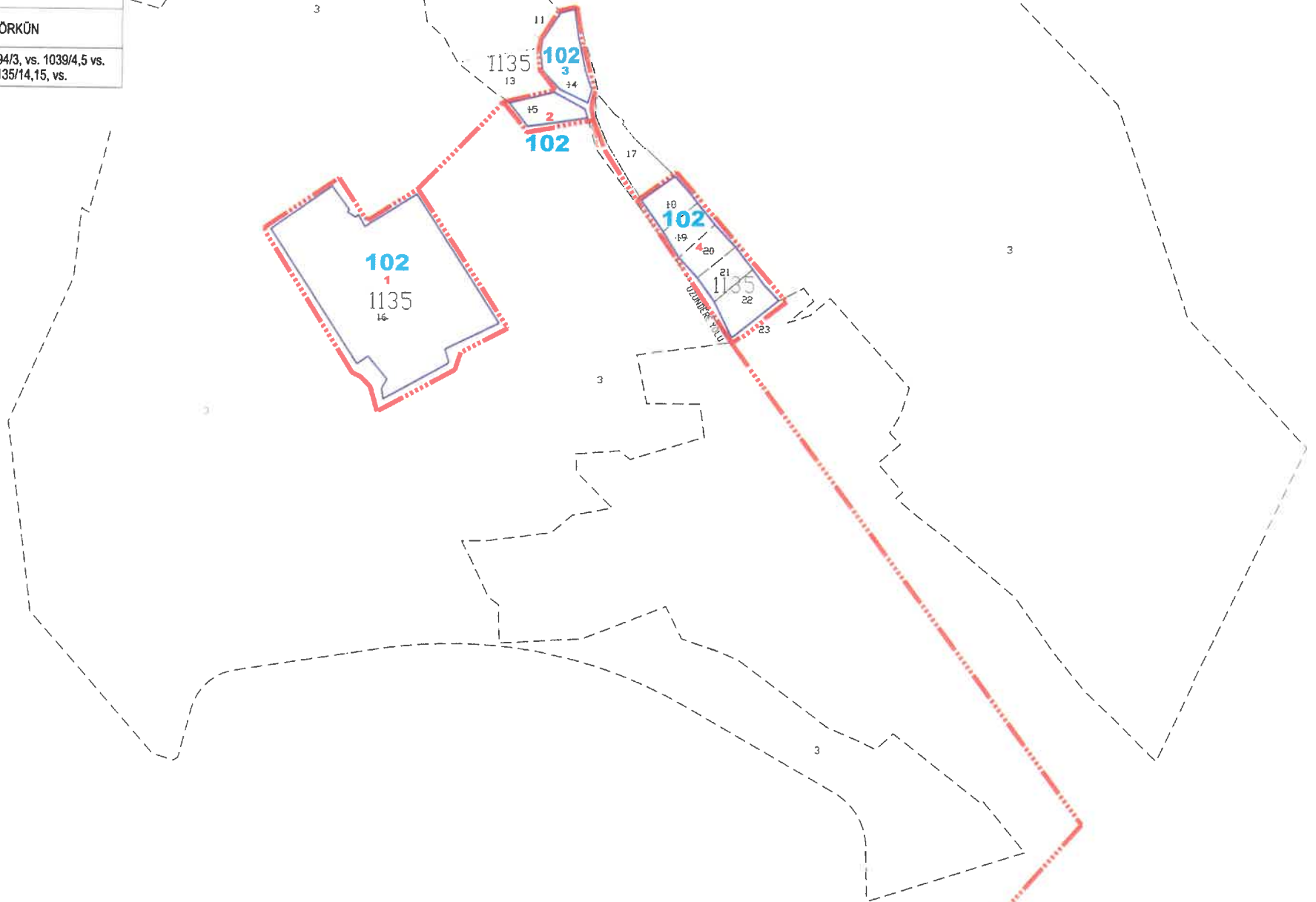

N
KROKİ

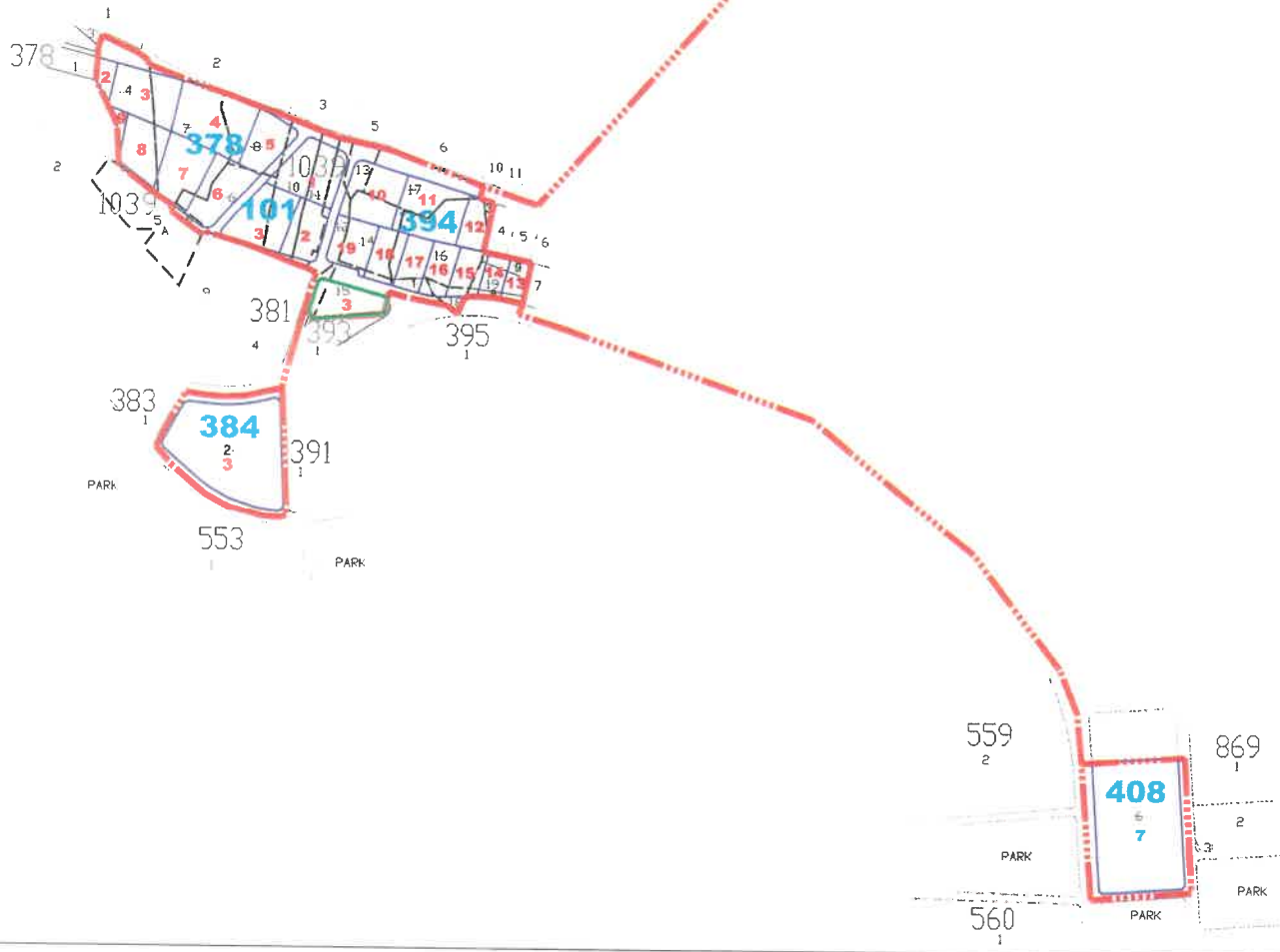

H. Emre MERMİ
Harita Mühendisi

— — — — — DÜZENLEME SINIRI