

GERİ DÖNÜŞÜM KROKİSİ 1

İLİ : GAZİANTEP
İLÇESİ : ŞAHİNBEY
MAHALLE: TEKSTİLKENT
ADA : 1558 / 6201
PARSEL : MUHTELİF

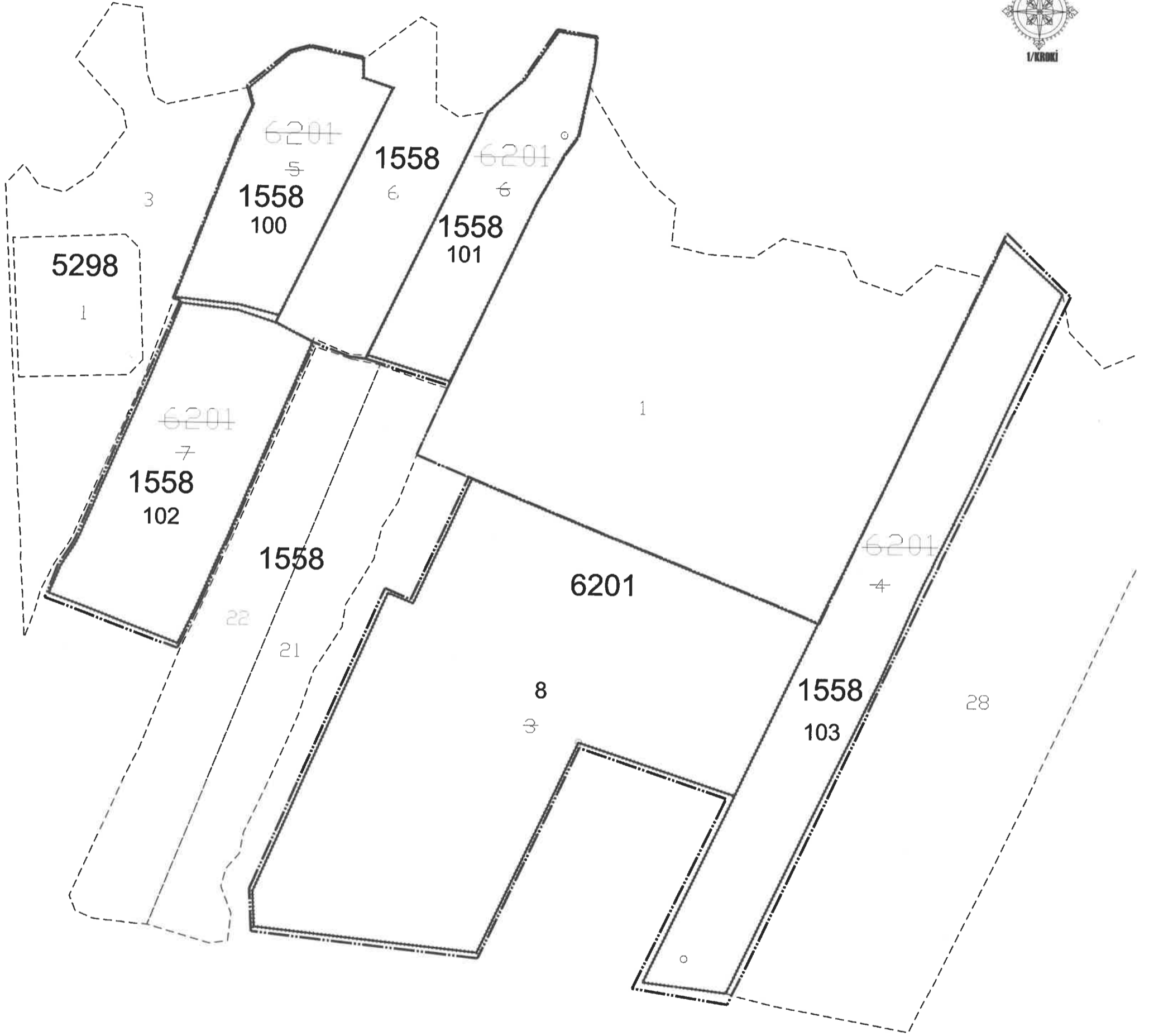

----- DÜZENLEME SINIRI

Hayri Emre MERMİ
Harita Mühendisi

GERİ DÖNÜŞÜM KROKİSİ 2

İLİ : GAZİANTEP
İLÇESİ : ŞAHİNBEY/ŞEHİTKAMİL
MAHALLE : KURTULUŞ-YEŞİLKENT/29 EKİM
ADA : 107-109..vs/3414-3612
PARSEL : MUHTELİF

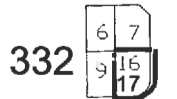
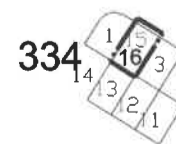
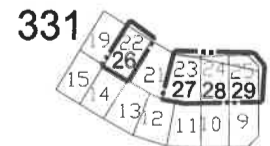
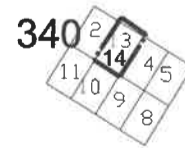
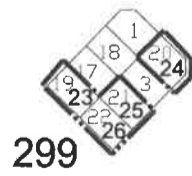
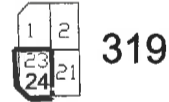
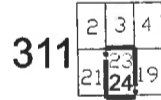
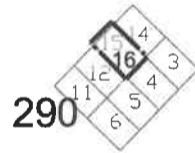
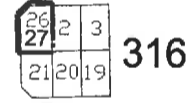
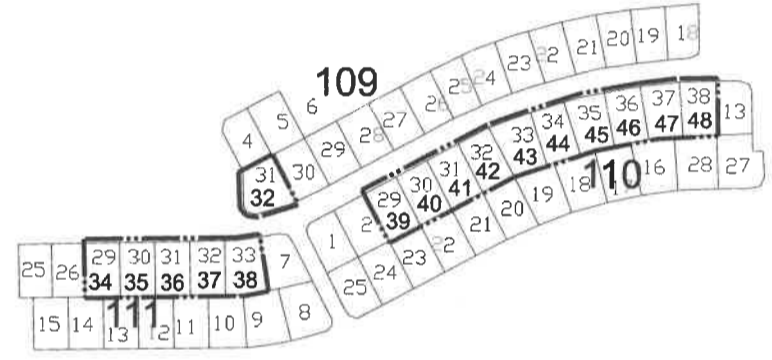
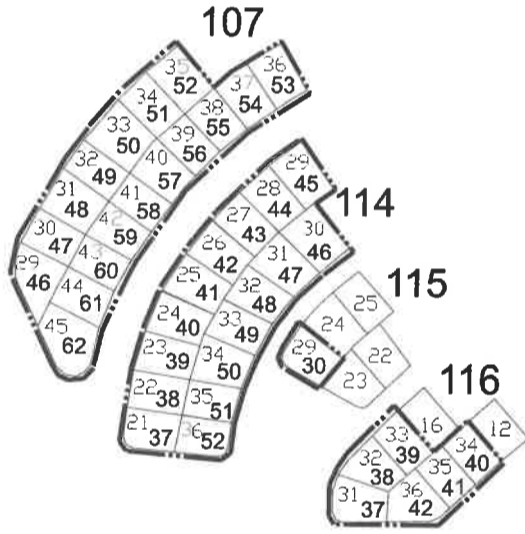
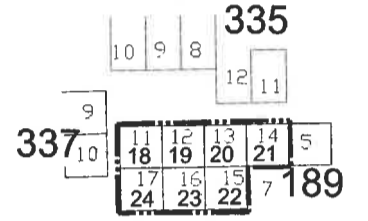

----- DÜZENLEME SINIRI

Hayri Emre MERMİ
Harita Mühendisi

PARSELASYON KROKİSİ 1

İLİ : GAZİANTEP
İLÇESİ : ŞAHİNBEY
MAHALLE: TEKSTİLKENT
ADA : 1558 / 6201
PARSEL : MUHTELİF

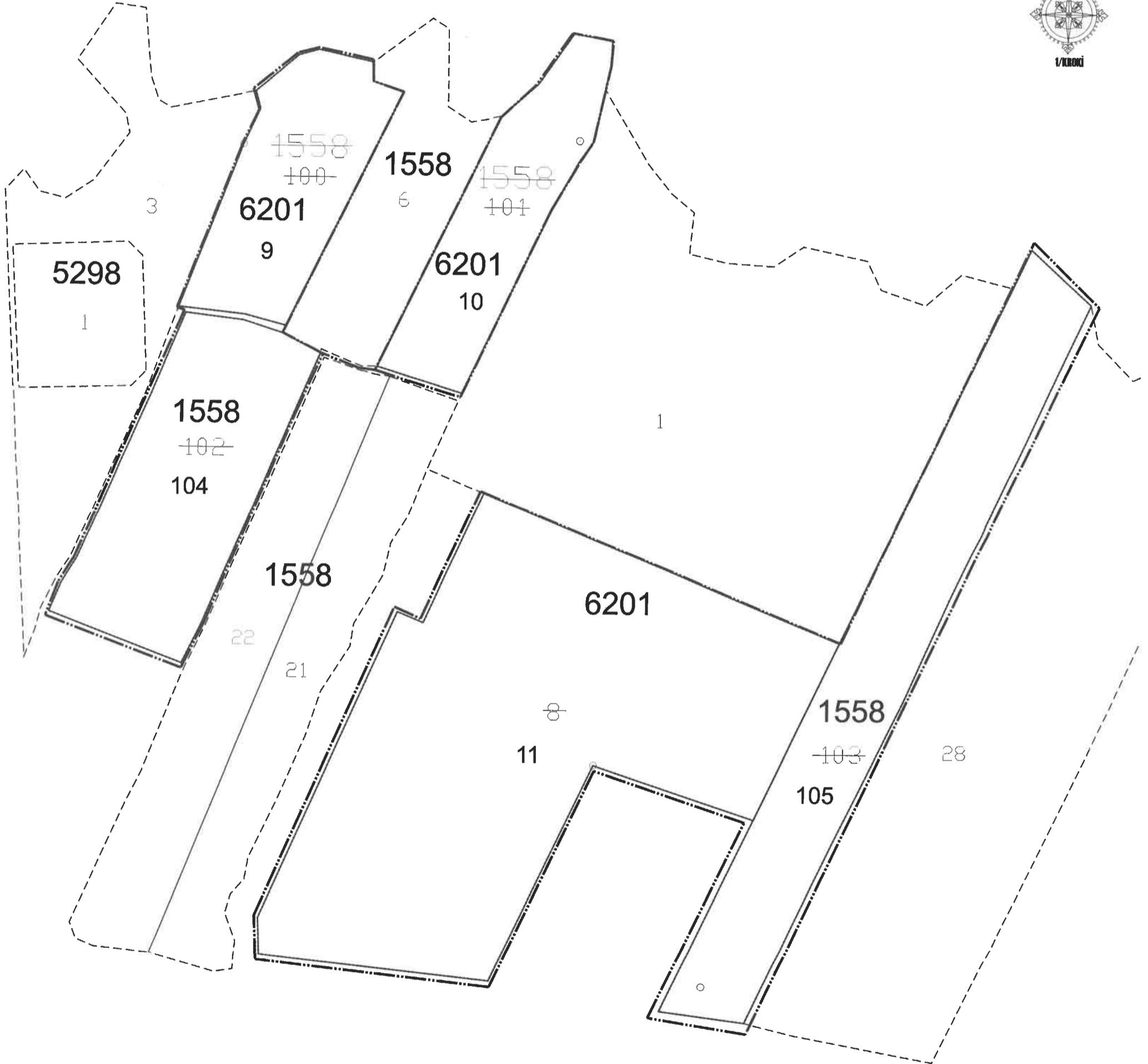

----- DÜZENLEME SINIRI

Hayri Emre MERMİ
Harita Mühendisi

PARSELASYON KROKİSİ 2

İLİ : GAZİANTEP
İLÇESİ : ŞAHİNBEY/ŞEHİTKAMİL
MAHALLE : KURTULUŞ-YEŞİLKENT/29 EKİM
ADA : 107-109..vs/3414-3612
PARSEL : MUHTELİF

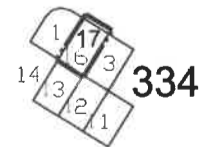
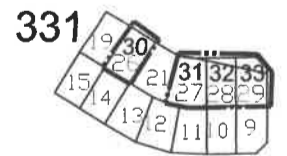
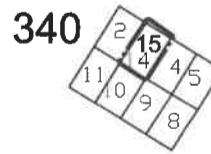
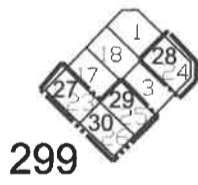
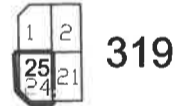
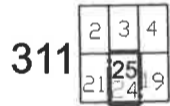
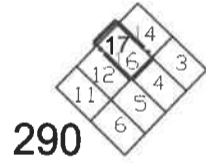
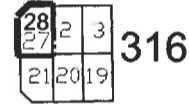
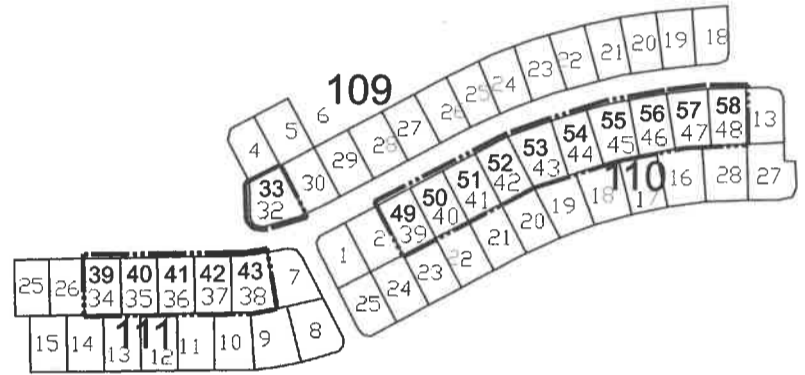
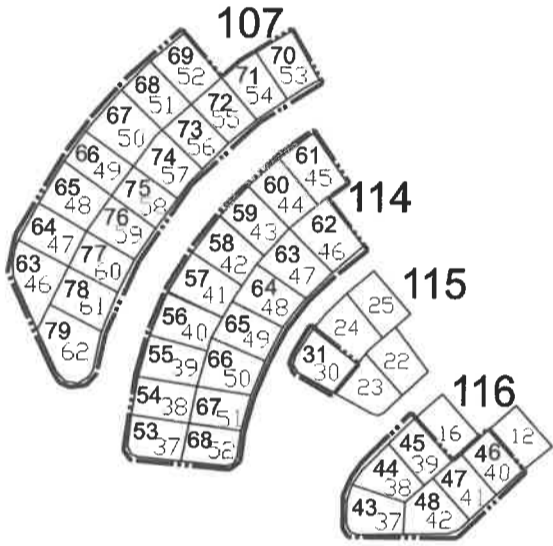
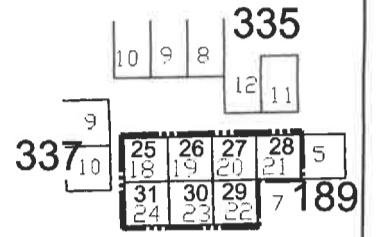

----- DÜZENLEME SINIRI

Hayri Emre MERMİ
Harita Mühendisi